

Atlas MRL



BREAKELL
LIFTS



Solutions BREAKELL LIFTS

Complete Lift Systems	Machine Room Hydraulic / Traction Systems
	Machine Room Less Hydraulic / Traction Systems
Lift Assemblies	MaisonLIFT PLUS
	MaisonLIFT BASIC , according to machine directive
	Earthquake Resistant Lift
	Compact, Dumbwaiter
Lift Assemblies	Cabins
	Passenger Cabins Freight/Goods Cabins Firefighting Cabins Panoramic Cabins
	Doors
	Automatic Doors with VWF Operator Folding Doors Semi-automatic Landing Doors Circular Doors Modernization Doors
	Electronics
	Controllers Car and Landing Operating Panels Pre-wiring
	Hydraulic Elevation Systems
	Piston and Cylinder Assembly Power Units Car Frames Guide Rails Wire Ropes Hydraulic Oil
	Traction Elevation Systems
	Traction Machines Car Slings Counterweight Slings Governors Guide Rails Wire Ropes
Complete Elevation Systems	KleemannPark
	Parking and Car Lifting Systems
	Freestair
	Chair or Platform Stair Lifting Systems
	Escalators and Moving Walks
Shaft Structures	Steel
	Aluminium

Atlas MRL

ATLAS MRL is the ideal traction Machine Roomless (MRL) solution for rated loads up to 5000 kg. It is equipped with a premium quality gearless motor and a state of the art inverter that lead to an outstanding ride quality, eliminate noise and achieve very low energy consumption. Furthermore, all lift components are cleverly designed to achieve efficient use of space inside the shaft as well as ease of installation and maintenance.

Advantages

- Wide range of application (from 180 kg / 2 persons up to 5000 kg / 66 persons)
- Premium ride quality through state of the art technology
- High energy efficiency (especially for high-rise buildings)
- Ease of installation
- Minimal requirements for pit and headroom dimensions (Atlas 2:1 RPH)
- Type Examination Certificate according to Directive 95/16EC and in compliance with EN81.1/A2, prEN 81.A3 and EN 81.21



Atlas
Mini



Atlas
2:1 - L

Technical Specifications	Atlas Mini ⁽⁴⁾							
			Atlas 2:1 - L ⁽⁵⁾					
			Atlas 2:1 RPH ⁽²⁾					
			Atlas 2:1 ⁽¹⁾				Atlas Basic ⁽³⁾	
Rated Load (Kg)	180	225	300	375 ⁽⁵⁾	450	630	750	
Persons	2	3	4	5	6	8	10	
Roping	2:1 ⁽¹⁾⁽²⁾⁽³⁾⁽⁴⁾⁽⁵⁾							
Max Travel (m)*	30 ⁽⁴⁾ 45 ⁽¹⁾⁽²⁾⁽³⁾⁽⁵⁾							
Max Number of Stops*	11 ⁽⁴⁾⁽⁵⁾ 16 ⁽¹⁾⁽²⁾⁽³⁾							
Max Speed (m/sec)*	1.6 ⁽¹⁾⁽³⁾⁽⁵⁾ 1.0 ⁽²⁾⁽⁴⁾							
Min Pit Depth (mm)	350 ⁽⁴⁾ 370 ⁽²⁾ 1100 ^{(1)(3)**}		1200 ^{(3)***} 1250 ^{(5)**} 1300 ^{(1)***}		1350 ^{(5)***}			
Min Headroom (mm)	2900 ⁽²⁾ 3450 ⁽¹⁾⁽³⁾⁽⁵⁾ 3600 ^{(1)(3)(5)***}							
Cabin Guide Rails	T75 x 62 x 10 ⁽¹⁾⁽²⁾⁽³⁾⁽⁴⁾⁽⁵⁾ T89 x 62 x 16 ⁽¹⁾⁽²⁾⁽³⁾⁽⁵⁾ T90 x 75 x 16 / T125 x 82 x 16 ⁽⁵⁾							
Counterweight Guide Rails	T50 x 50 x 5 / T75 x 62 x 10 ⁽¹⁾⁽²⁾⁽³⁾⁽⁴⁾⁽⁵⁾							
Vertical Distance Between Guide Brackets (vDBG) (mm)	1500mm ⁽⁴⁾ 2000mm / 1750mm ⁽¹⁾ 2000mm ⁽²⁾⁽³⁾			1250mm (T90 x 75 x 16 / T50 x 50 x 5) ⁽⁵⁾ 1500mm (T89 x 62 x 16 / T50 x 50 x 5) ⁽⁵⁾ 1500mm (T125 x 82 x 16 / T50 x 50 x 5) ⁽⁵⁾				
Number and Diameter of Ropes	7~12 x Ø4 ⁽²⁾ 6 x Ø6.5 ⁽⁴⁾ 6~8 x Ø6.5 ⁽¹⁾⁽³⁾⁽⁵⁾							
Max Number of Cabin Doors	2 ⁽¹⁾⁽²⁾⁽³⁾ 3 ⁽⁴⁾⁽⁵⁾							
Motor Type	Gearless, VVVF, Permanent Magnet, Closed Loop with Inverter ⁽¹⁾⁽²⁾⁽³⁾⁽⁴⁾⁽⁵⁾							

(1) Atlas 2:1 (2) Atlas 2:1 RPH (3) Atlas Basic (4) Atlas Mini (5) Atlas 2:1L * Maximum car travel, number of stops & car speed may exceed the respective figures. Contact us for further details.

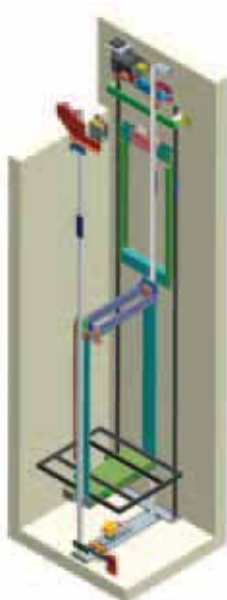

Atlas
2:1 RPH

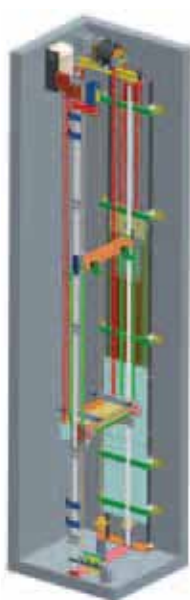

Atlas 2:1
Atlas Basic

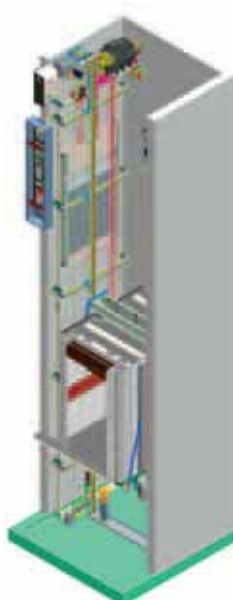

Atlas
Gigas

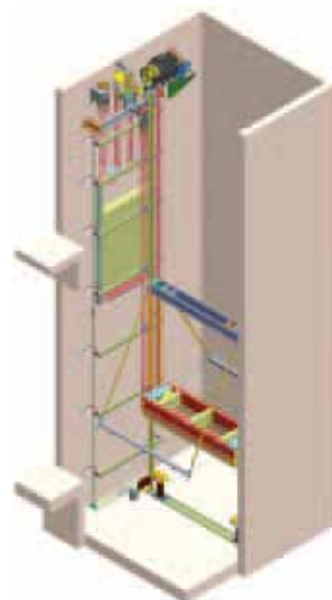

Atlas
Super Gigas

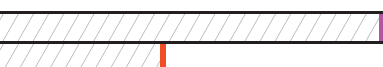

	Atlas Gigas					Atlas Super Gigas				
1000 ⁽¹⁾⁽³⁾⁽⁵⁾	1275	1600	1800	2000	2500	3000	3500	4000	4500	5000
13 ⁽¹⁾⁽³⁾	17	21	24	26	33	40	46	53	60	66
	2:1					4:1				
	45					45				
	16					16				
	1.6					1.0				
	1400					1400				
	3450					3800				
	T125 x 82 x 16					T125 x 82 x 16				
	T75 x 62 x 10 or T89 x 62 x 16					T75 x 62 x 10 or T89 x 62 x 16				
	2000					2000				
	8 x Ø10					10 x Ø10				
	2					2				
	Gearless, VVVF, Permanent Magnet, Closed Loop with Inverter					Gearless, VVVF, Permanent Magnet, Closed Loop with Inverter				

**v≤1.0 m/s

***v>1.0 m/s